

Thermal Insulation, Anti Corrosion,
Water Proofing For Metal Roof



Reduces Roof temperature up to 30 %
Reflects Radiant Heat 98 %

SM
ADHESIVES

Manufacturing & Application under one roof

SMAC™ ANTICORR RC (WATER BASE RUST CONVERTER)

Description :

SMAC™ ANTICORR RC is polymeric base rust converter cum inhibitor which converts Rust into non rusty stable metal complex and protects from further corrosion.

Application Procedure :

First remove all loose particles using wire brush, clean the surface by water to remove oil, grease contaminated on the surface. Then apply ANTICORR RC which converts rust into 30 minutes

Coverage : 150 sq. ft /kg.

Working Principles :

When SMAC™ ANTICORR RC is applied on rusted metal it converts rust into stable metallic complex and form hydrophobic and polymeric layer to protect from further corrosion.

Application Areas :

Chemical Plants, Construction Projects, Shipping Industries, Railways, Automobiles, Industrial Steel Structure and all Other Industries where Corrosion is present.

Packing : 20 kg, 50 kg.

Shelf life : 12 months sealed container.

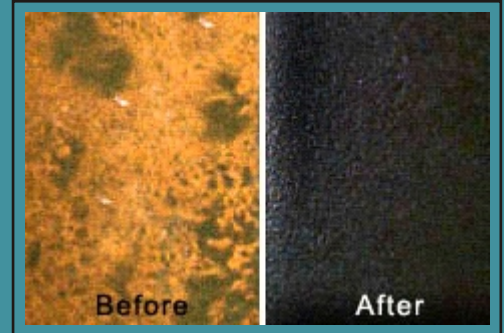

SMAC™ ELASTOBOND PU (WATER BASE ANTICORROSIVE COATING)

Description :

SMAC™ ELASTOBOND PU is aliphatic polyurethane polymeric base anticorrosive cum thermal insulation coating made from latest multi ceramic and nano technology.

Advantages :

- Reduces temperature 10 to 15 °c
- No primer required.
- Thermal insulation.
- Eco friendly.
- Corrosion resistance.
- Chemical resistance.
- Water resistance.
- Solvent resistance.
- Anti fungus.



Technical Data :

- Base : aliphatic polyurethane polymer.
- Solid content : 50-52%.
- Modifier : multi ceramic microsphere and polysiloxane.
- Viscosity : 250 to 500 cps.
- Ph : 8.5 to 9.
- Flexibility : 150%.

Application Areas :

Industrial Metal Roof

Chemical storage tank, pipe line, pumps, valves, motors, construction machinery air conditioning duct, transformers and all steel structures where corrosion resistance & reduction of heat is desired.

Packing : 20 kg, 50 kg.

Shelf life : 12 months sealed container.

SHEETWALL JUNCTION WATER PROOFING SYSTEM

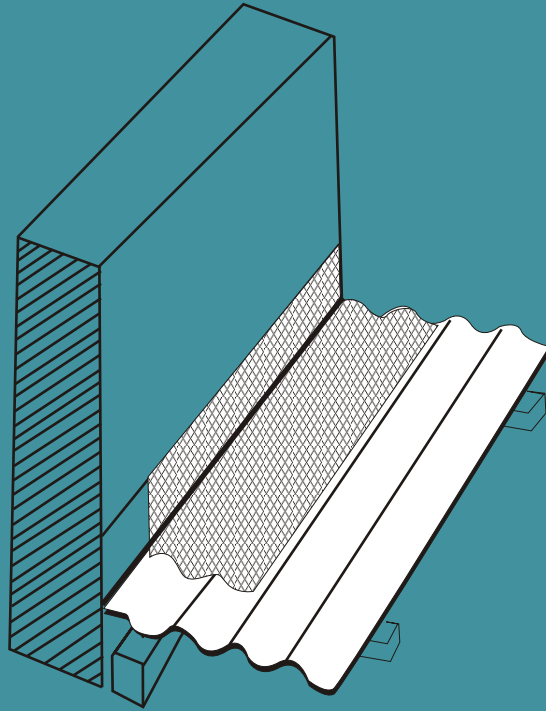

Providing & Applying PU Base Flexible Water Proofing layer sandwich with Polypropylene double layer membrane over the sheet & wall section.

SHEET OVERLAPS SECTION WATER PROOFING SYSTEM

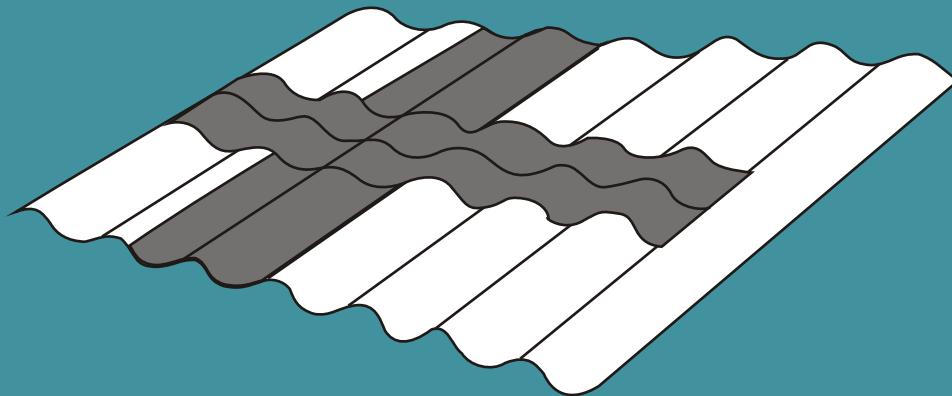

Providing & Applying PU Base Flexible Water Proofing layer sandwich with Polypropylene double layer membrane over the sheet overlaps section.

CONCRETE / METAL GUTTER WATER PROOFING SYSTEM

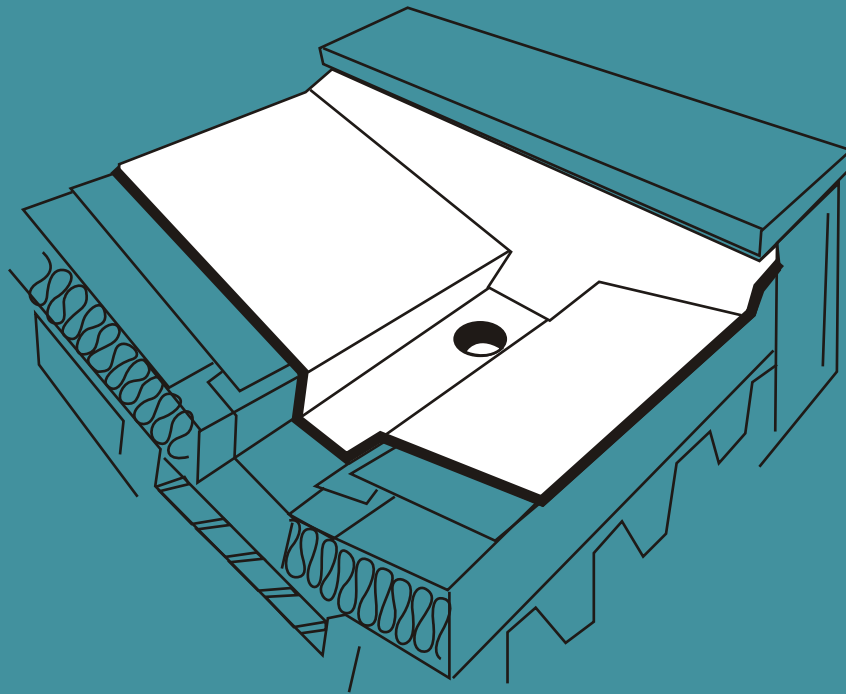

Providing & Applying PU Base Flexible Water Proofing layer sandwich with Polypropylene double layer membrane between the concrete / metal gutter section.

DRAIN OUTLETS WATER PROOFING SYSTEM

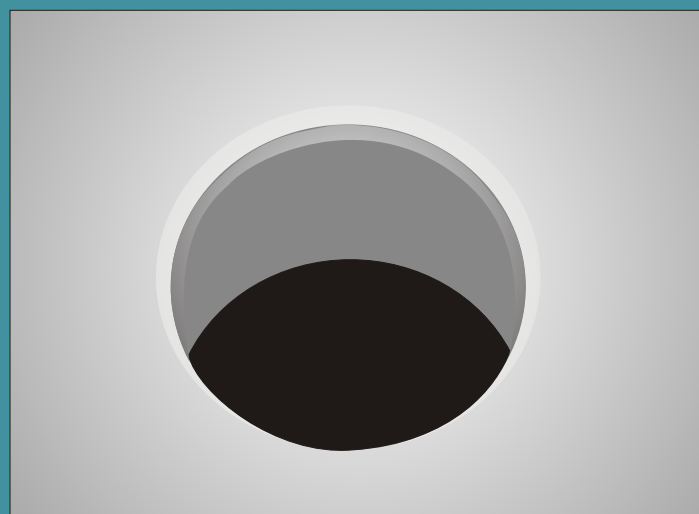

Providing & Applying PU Base Flexible Water Proofing layer sandwich with Polypropylene double layer membrane over the junction of the drain.

Applications



Metal roofing



Pipeline



Marine



Storage Tank



Automobiles



Construction

Benefits of the system

Reflects radiant Heat

Reduces roof temperature

Protect roof from corrosion

Stop water leakage from similar as well as dissimilar substrate

Metal roof gets, Water Proof , Rust Proof & Heat Proof



Shop no.4, Ganga Bhuvan Srps road , Opp.Chetna
Apartment, Bhandup (W)
Tel No. 91-22-32608690 / 32976162

Reg.Office : Godrej Edenwoods 4 A2, Oak House,
Pawar Nagar, Thane (W).
Tel.No.91-22-25891320

Email : atul_awade@hotmail.com

Website : www.smadhesives.com