

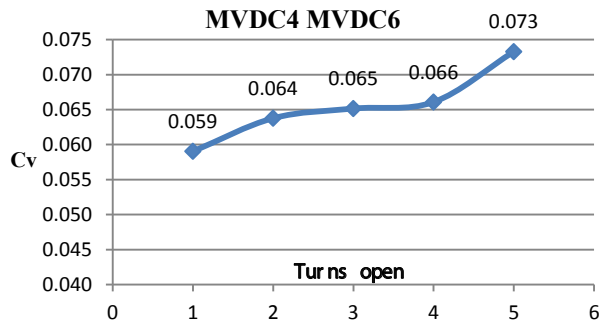

CARBON STEEL MINI NEEDLE VALVE SERIES: MVDC

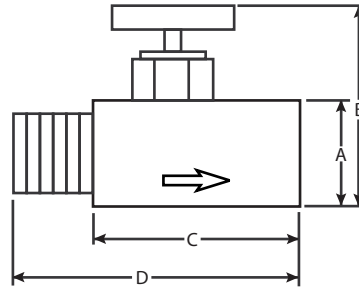

SPECIFICATIONS

RATED TO 6,000 PSI
CARBON STEEL CONSTRUCTION
VITON PACKING AND SEALS
WORKING TEMPERATURE -20 DEG F TO 200 DEG F
THREADS CONFORM TO ASME B1.20.1
AVAILABLE IN MxM, MxF AND FxF
NACE MR0175

PART	MATERIAL
ROUND KNOB	CARBON STEEL
STEM	304 STAINLESS STEEL
BONNET	CARBON STEEL
VALVE BODY	CARBON STEEL

DIMENSIONS

NPS	PART #	STYLE	WEIGHT	A	B	C	D
1/4"	MVDC4	FxF	0.66	.75"	1.71"	1.31"	1.81"
1/4"	MVDC5	MXM	0.66	.75"	1.71"	1.31"	1.81"
1/4"	MVDC6	MXF	0.66	.75"	1.71"	1.31"	1.81"

* Due to the continuous development of our products, design or construction may change without prior notice



STAINLESS STEEL MINI NEEDLE VALVE SERIES: MVDS

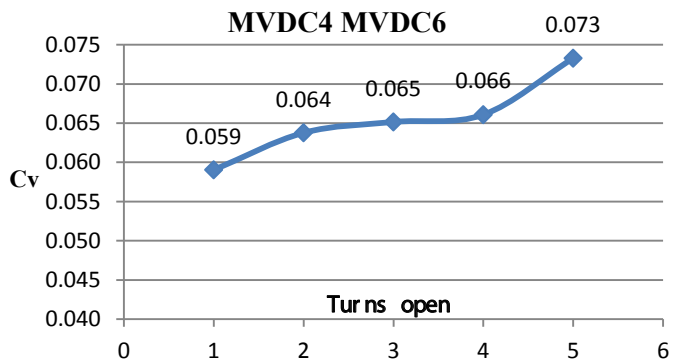
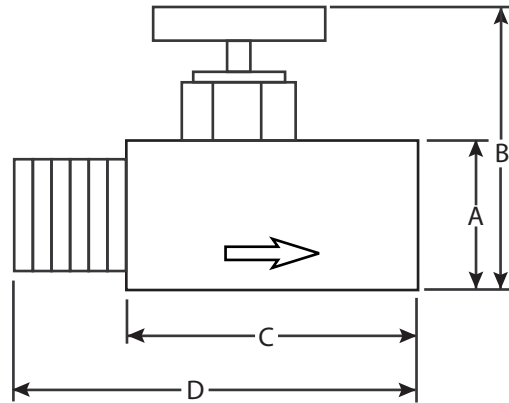

SPECIFICATIONS

- RATED TO 6,000 PSI**
- STAINLESS STEEL CONSTRUCTION**
- VITON PACKING AND SEALS**
- WORKING TEMPERATURE -20 DEG F TO 200 DEG F**
- THREADS CONFORM TO ASME B1.20.1**
- AVAILABLE IN MxM, MxF AND FXF**
- NACE MR0175**

PART	MATERIAL
ROUND KNOB	303 STAINLESS STEEL
STEM	304 STAINLESS STEEL
BONNET	316 STAINLESS STEEL
VALVE BODY	316 STAINLESS STEEL

DIMENSIONS

NPS	PART #	STYLE	WEIGHT	A	B	C	D
1/4"	MVDS4	FXF	0.66	.75"	1.71"	1.31"	1.81"
1/4"	MVDS5	MXM	0.66	.75"	1.71"	1.31"	1.81"
1/4"	MVDS6	MXF	0.66	.75"	1.71"	1.31"	1.81"

* Due to the continuous development of our products, design or construction may change without prior notice