



## FLEXIBLE DRIVE COUPLING

(MODEL: Hydax 19, 28, 38, 48, 65)

### TECHNICAL DATA

The Hydax Flexible Drive Coupling consists of two gear hubs engaging in a sleeve of high grade plastic material. This material has superior strength and a wide operating temperature range. The gears have crowned-tooth form which permit axial and angular misalignment. The couplings have undergone extensive testing under severe load conditions. They are easy to assemble and require no maintenance or lubrication and do not emit transmission noise. Available in non-corrosive options of Stainless Steel and Nylon materials also.

### ASSEMBLY PROCEDURE

Maximum permissible angular misalignment is 1.5 degrees. Ensure that the coupling hubs easily fit on the shaft. Do not use undue force. Maintain gap between hubs as shown in sketch. Use grub screws to locate gear hubs on their respective shafts. For shock load applications use the following formula:

$$\text{Rating / 100 RPM of coupling} = \frac{\text{HP of application} \times 100 \times F}{\text{RPM of application}}$$

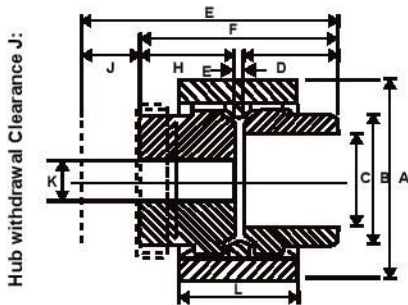

### SALIENT FEATURES

- Applicable to all range of hydraulic equipment and in the Transmission market.
- Maintenance free, no lubrication.
- Gears in the crowned-tooth form permit axial and angular Misalignment.
- Cost effective and easy to assemble.
- Two drive hubs engaging in a sleeve.
- Compact and streamlined.
- Available in five sizes to suit 1HP to 75HP.
- Available in non-corrosive options of Stainless Steel and Nylon materials also.

	Load Factor	Load Factor (F)
Application	El Motor	IC Engines
Uniform Load	1	1.2
Medium Shock	1.25	1.5
Heavy Shock	1.75	2.0

Coupling size	φA	φB	Max. φC	D	E	F	G	H	J	Min. φK	L	Pilot Bore
HYDAX - 19	48	30	19	25	4	54	70	25	16	7	37	7
HYDAX - 28	66	44	28	40	4	84	104	40	20	12	46	12
HYDAX - 38	83	56	38	40	4	84	104	40	24	12	48	12
HYDAX - 48	100	68	48	50	6.5	104	126	50	22	15	50	15
HYDAX - 65	140	96	65	70	4	144	176	70	32	15	72	15

### Specification for Hydax Flexible Drive Coupling

Coupling Size	Elec. Motor Frame Size	3000 RPM		1500 RPM		1000 RPM		750 RPM		Max. Torque at 1500 RPM		Max. RPM
		kW	Hp	kW	Hp	kW	Hp	kW	Hp	Kg.M	Ft. Lbs	
Hydax 19	80 90S, 90L	2.2	2	1.5	1	1.1	1	.75	1	.5	3.6	3000
Hydax 28	100L 112 M	7.5	10	5.5	5	4.25	5	2.2	3	2.3	16.6	3000
Hydax 38	132 S 132 M	10	13	7.5	10	5.5	7.5	3	4.5	7	4.9	3000
Hydax 48	160 M.L. 180 M.L.	22	30	18.5	25	15	20	11	15	14.4	104	3000
Hydax 65	200 L 250 M	55	75	55	75	37	50	30	40	35.5	256	3000