

FILTER - TANK / LINE MOUNTED - CFR

- DIRECT TANK OR LINE MOUNT
- 5 SIZES - FLOWS TO 700 LPM
- BY PASS STANDARD 1 BAR RETURN / 0.35 BAR SUCTION
- ALUMINIUM DIECAST CONSTRUCTION
- WORKING PRESSURE TO 20 BAR / TEST 30 BAR / BURST 40 BAR
- CAN BE USED FOR RETURN / SUCTION LINES
- MAX TEMP. TO 80° C
- SUITABLE FOR MINERAL / PETROLEUM BASED OILS

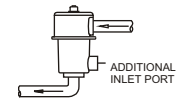

LINE MOUNTING

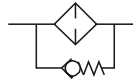
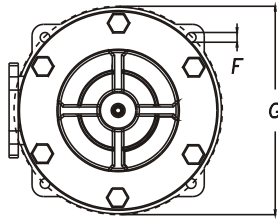
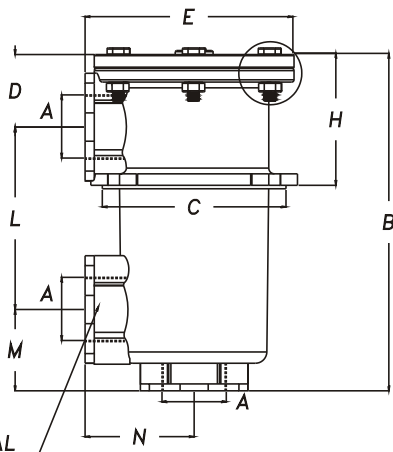

ADDITIONAL INLET PORT

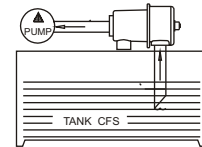
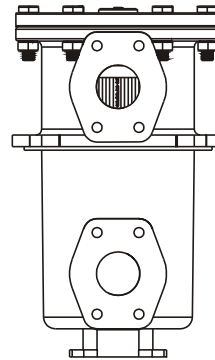

TANK CFS

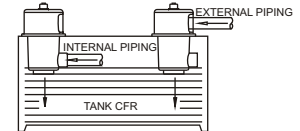

TANK CFR

MODEL	PORT 'A' BSPP	TANK B	TANK CUT OUT C	D	E	F	G	H	L	M	N	WT KGS
CFR* - 025	1/2"	117	83	29	98	5.6	93	46	56	33	52	0.8
CFR* - 040	3/4"	176	121	43	117	6.5	138	77	110	26	58	2.0
CFR* - 100	1"	257	134	64	143	6.5	154	113	140	52	71	3.2
CFR* - 250	1 - 1/2"	300	161	65	182	8.5	180	117	159	77	88	5.5
CFR* - 630	2 - 1/2" SAE-FL	353	232	78	244	10.5	275	146	178	95	124	10.0

FILTER - TANK / LINE MOUNTED - CFR



MODEL CODE : ASSEMBLY

CFR 2	- 0 2 5	- 04*	- 0 1 0	- *	- *
SERIES	SIZE	PORT CONNECTION INCH	FILTRATION μ MICRONS	FEATURE BY Pass (OMIT IF STD)	FEATURE SPECIAL #
R - RETURN	0 2 5	04 B - 1/2" BSPP	P10 - 10 μ NOM P25 - 25 μ NOM A10 - 10 μ ABS A25 - 25 μ ABS M 149 - 149 μ MESH M 74 - 74 μ MESH	R3 - 15PSI (STD) R4 - 25 PSI S1 - 3PSI (STD) S2 - 5PSI	1 - SAE FLANGE WITH M12x1.75 (STD) 2 - SAE FLANGE WITH 1/2"UNC-13 (OPTIONAL) OMIT IF STD.
		04 N - 1/2" NPT			
		08 S - 3/4" UNF - 16			
S - SUCTION	0 4 0	06 B - 3/4" BSPP			
		06 N - 3/4" NPT			
		12 S - 1-1/16" UNF - 12			
2 - ADDL INLET PORT (OPTIONAL #)	1 0 0	08 SF - 1" SAE FLANGE			
		08 B - 1" BSPP			
		08 N - 1" NPT			
2 5 0	1 0 0	16 S - 1-5/16" UNF - 12			
		12 SF - 1-1/2" SAE FLANGE			
		12 B - 1-1/2" BSPP			
6 3 0	2 5 0	12 N - 1-1/2" NPT			
		24 S - 1- 7/8" UNF - 12			
		20 SF - 2-1/2" SAE FLANGE			

Consult Factory For Tapped Holes For Cover Bolts

INDICATOR : OPTIONAL (TO BE ORDERED SEPERATELY)

Element : P10 / P25 Was 010 / 025

GR - VISUAL RETURN

ER - ELEC. RETURN

GS - VISUAL SUCTION

ES - ELEC. SUCTION

MODEL CODE : ELEMENT

CE	- 0 2 5	- 0 1 0	- Feature
SERIES	SIZE	FILTRATION μ MICRONS	- # Omit If Standard
CE	0 2 5	P10 - 10 μ NOM	S3 - 10 BAR Collapse Strength
	0 4 0	P25 - 25 μ NOM	
	1 0 0	A10 - 10 μ ABS	
		A25 - 25 μ ABS	
	2 5 0	M149 - 149 μ MESH	
	6 3 0	M74 - 74 μ MESH	

MODEL CODE : SEALKIT

CFR	- 0 2 5	-SK
SERIES	SIZE	SEALKIT
CFR	0 2 5	SK
	0 4 0	SK
	1 0 0	SK
	2 5 0	SK
	6 3 0	SK

* Optional Filtration Mesh Elements Available
M43 , M63 , M100 ,M125, M300 & M575 microns

Element Details Ht

SIZE	D φ	B φ	H	Area SqCm		
				P-10/25	A-10/25	M - ***
CE - 025	52	25.0	72	710	500	325
CE - 040	70	34.5	86	1750	1250	600
CE - 100	70	34.5	130	2650	1880	900
CE - 250	100	51.0	210	7900	5500	2200
CE - 630	135	75.0	250	14500	10100	3500

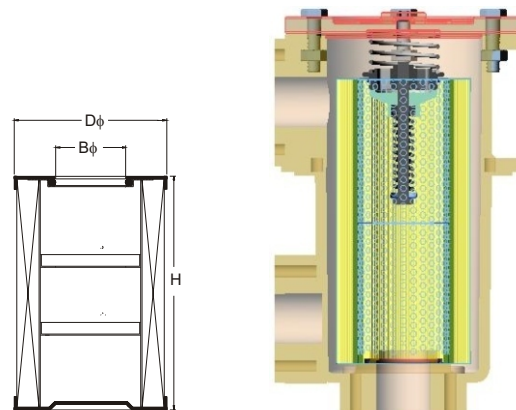

M *** All Mesh Elements

CONSULT FACTORY FOR ANY OTHER REQUIREMENT

DIMENSIONS IN MM FOR REFERENCE ONLY

FILTER - INLINE - HFR

- ALUMINIUM DIE CAST CONSTRUCTION
- 3 BASIC MODELS - FLOWS TO 150 LPM
- BY PASS STANDARD 1 BAR
- WORKING PRESSURE TO 20 BAR / TEST 30 BAR / BURST 40 BAR
- MAX TEMP. TO 80° C
- SUITABLE FOR MINERAL / PETROLEUM BASED OILS

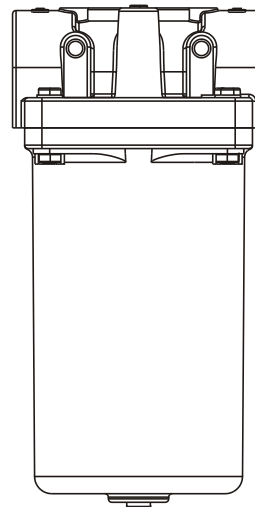
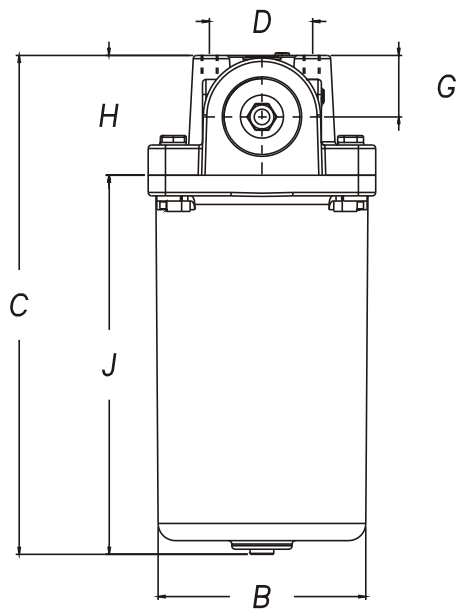
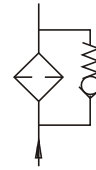
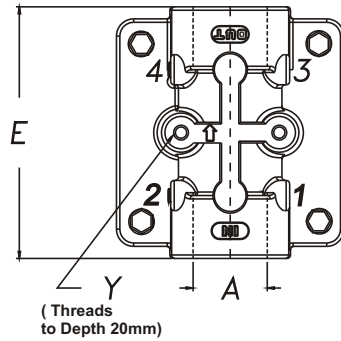

MODEL	PORT 'A' BSPP	B	C	D	E	G	H	J	Y 2 OFF	WT KGS
HF * .05	1 / 2"	66	147	38	88	24	44	103	M 8x 1.25	1.0
HF * .10	3/4" 1"	88	176	44	114	27	52	125	M 8x1.25	1.6
HF * .20	1 - 1 / 4" 1 - 1 / 2"	120	290	57	145	36	70	220	M 10x1.5	3.8

FILTER - INLINE - HFR



MODEL CODE : ASSEMBLY

HF	R	- 05	- 04*	- 010	- **	- **	- **	
TYPE	SIZE	PORT THREAD		FILTRATION*	FEATURE 1	FEATURE 2	FEATURE 3	
				μ MICRONS	BY Pass (OMIT IF STD)	Position Indicator Ports (OMIT IF STD)		
R - RETURN	05	04 B	- 1/2" BSPP	P10 - 10 μ NOM	R3 - 15PSI (STD)	R-STD	2 X 1/8" NPT INLET (1 & 2)	
		04 N	- 1/2" NPT					
		08 S	- 3/4" UNF - 16					
S - SUCTION	10	06 B	- 3/4" BSPP	P25 - 25 μ NOM	R4 - 25 PSI	S-STD	2 X 1/8" NPT OUTLET (3 & 4)	
		06 N	- 3/4" NPT					
		12 S	- 1-1/16" UNF - 12					
B - NO BYPASS	20	08 B	- 1" BSPP	A10 - 10 μ ABS	S1 - 3PSI (STD)	B-STD	4 X 1/8" NPT INLET & OUTLET (1 , 2 , 3 & 4)	
		08 N	- 1" NPT					
		16 S	- 1-5/16" UNF - 12	A25 - 25 μ ABS				
		10 B	- 1-1/4" BSPP	M149 - 149 μ MESH				S2 - 5PSI
		10 N	- 1-1/4" NPT					
		20 S	- 1- 5/8" UNF - 12					
12 B	- 1-1/2" BSPP	M074 - 74 μ MESH						
12 N	- 1-1/2" NPT							
24 S	- 1- 7/8" UNF - 12							

* Optional Filtration Mesh Elements Available **43 , 63 , 100 , 125, 300 & 575 microns** **INDICATOR** : OPTIONAL (TO BE ORDERED SEPERATELY)

Consult Factory For HFR 20 - 1" Port Option

Consult Factory For Tapped Holes For Cover Bolts

Element : P10 / P25 Was 010 / 025

GR - VISUAL RETURN **ER** - ELEC. RETURN

GS - VISUAL SUCTION **ES** - ELEC. SUCTION

MODEL CODE : ELEMENT

HFE	- 05	- 010
	SIZE	FILTRATION
		μ MICRONS
HFE	05	P10 - 10 μ NOM
		P25 - 25 μ NOM
	10	A10 - 10 μ ABS
		A25 - 25 μ ABS
	20	M149 - 149 μ MESH
		M 74 - 74 μ MESH

* Optional Filtration Mesh Elements Available
M43 , M63 , M100 , M125, M300 & M575 microns

MODEL CODE : SEALING KIT

HFR	- 05	- SK	- **
	SIZE	SEAL KIT	FEATURE
			# OPTIONAL
HFR	05	SK	
	10	SK	
	20	SK	

OPTIONAL / SPECIAL FEATURE - OMIT IF NOT REQUIRED

Element Details

SIZE	P/A	M	Area SqCm				
	D φ	D φ	B φ	H	P-10/25	A-10/25	M - ***
HFE - 05	52	52	25	90	920	655	360
HFE - 10	72	66	34	109	2205	1575	560
HFE - 20	100	85	51	200	7235	5150	1800

M *** All Mesh Elements

CONSULT FACTORY FOR ANY OTHER REQUIREMENT

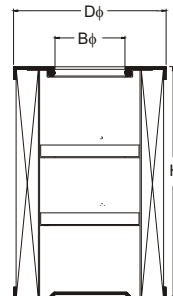

FILTER - TANK IMMERSED - TIF2

- DIRECT TANK MOUNTING
- PRESSURE - MAX. 10 BAR / TEST 20 BAR / BURST 25 BAR
- ALL ALUMINIUM DIECAST CONSTRUCTION
- 4 - SIZES FLOWS TO 175 LPM
- BY PASS STANDARD 1 BAR
- ELEMENTS REPLACEABLE THROUGH COVER
- SUITABLE FOR MINERAL / PETROLEUM BASED OILS
- MAX TEMP. 80 deg C

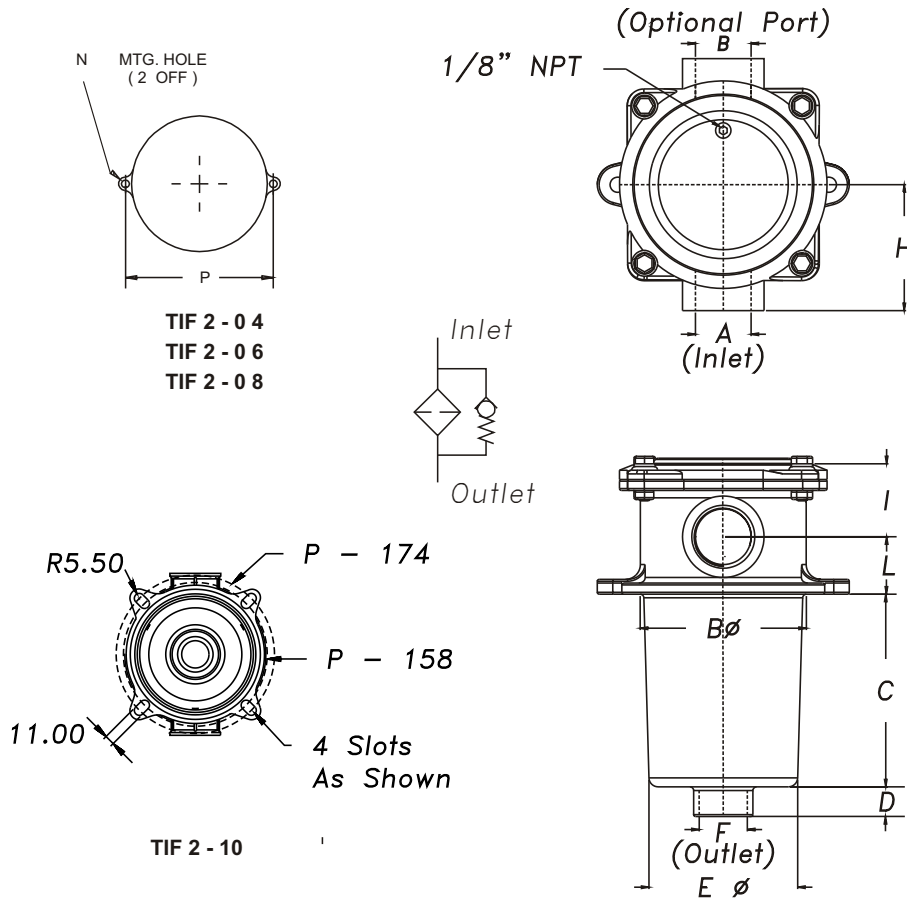

MODEL	PORT 'A' BSPP	PORT 'B' BSPP	TANK CUT OUT B	C	D	E	PORT 'F' BSPP	H	I	L	N	P	WT KGS
TIF2 - 04	1 / 2"	-	64	60	15	62	1 / 2"	51	28	24	6.6	90	0.7
TIF2 - 06	3 / 4"	-	86	75	15	81	3 / 4"	69	34	26	8.2	114	1.4
TIF2 - 08	1"	-	86	104	15	81	3 / 4"	68	37	32	8.4	114	1.5
TIF2 - 06 / 08	1"	3 / 4"	86	104	15	81	3 / 4"	68	37	32	8.4	114	1.5
TIF2 - 10	1 - 1 / 4"	1 - 1 / 4"	129	215	20	122	1 - 1 / 4"	88	54	44	10.5	158 174	4.3

FILTER - TANK IMMERSED - TIF2



MODEL CODE : ASSEMBLY

TIF 2	- Port A (Std)	- Port B (Optional)	- Element	- Feature	
Series	PORT THREAD	PORT THREAD Omit If Not Req'd	- Filtration Micron	- # Omit If Standard	
2 - ALL CAST	04 B - 1/2" BSPP		P10 - 10µ NOM	R3 - 15 PSI BYPASS STANDARD	
	04 N - 1/2" NPT		P25 - 25µ NOM		
	08 S - 3/4" UNF - 16		A10 - 10µ ABS		
	06 B - 3/4" BSPP		A25 - 25µ ABS		
	06 N - 3/4" NPT		M149 - 149µ MESH		R4 - 25 PSI BYPASS OPTIONAL
	12 S - 1-1/16" UNF - 12		M100 - 100µ MESH		
	08 B - 1" BSPP	06 B - 3/4" BSPP	M074 - 074µ MESH		
	08 N - 1" NPT	06 N - 3/4" NPT	M063 - 063µ MESH		
	16 S - 1-5/16" UNF - 12	12 S - 1-1/16" UNF - 12			
	10 B - 1-1/4" BSPP	10 B - 1-1/4" BSPP			
	10 N - 1-1/4" NPT	10 N - 1-1/4" NPT			
	20 S - 1- 5/8" UNF - 12	20 S - 1- 5/8" UNF - 12			

INDICATOR : OPTIONAL (TO BE ORDERED SEPERATELY)

OPTIONAL / SPECIAL FEATURE - OMIT IF NOT REQUIRED

GR - VISUAL RETURN ER - ELEC. RETURN

Consult Factory For Tapped Holes For Cover Bolts

GS - VISUAL SUCTION ES - ELEC. SUCTION

Element : P10 / P25 Was 010 / 025

MODEL CODE : ELEMENT

TIE	- 08	- 010	- Feature	
SERIES	SIZE	FILTRATION µ MICRON	- # Omit If Standard	
TIE	04	P10 - 10 µ NOM	R3 - 15 PSI BYPASS STANDARD	
		P25 - 25 µ NOM		
	06	A10 - 10 µ ABS		
		A25 - 25 µ ABS		
	08	M149 - 149 µ MESH		R4 - 25 PSI BYPASS OPTIONAL
		M100 - 100 µ MESH		
10	M074 - 074 µ MESH			
	M063 - 063 µ MESH			

WITH BYPASS

MODEL CODE : SEAL KIT

TIF2	- 08	-SK
SERIES	SIZE	SEAL KIT
TIF2	04	SK
	06	SK
	08	SK
	10	SK

OPTIONAL / SPECIAL FEATURE - OMIT IF NOT REQUIRED

Element Details

SIZE	D φ	B φ	H	Area SqCm		
				P-10/25	A-10/25	M - ***
TIE - 04	52	25.5	72	710	500	325
TIE - 06	66	30.5	85	1225	875	425
TIE - 08	66	30.5	130	2450	1750	665
TIE - 10	100	40.5	245	6120	4300	2360

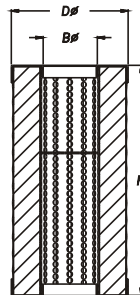

M *** All Mesh Elements

CONSULT FACTORY FOR ANY OTHER REQUIREMENT

