

HPV3M SERIES – HIGH PRESSURE HIGH SPEED SINGLE PUMPS

These HPV3M pumps are designed for high-pressure applications. Suitable for mobile applications like drill rigs, Railways & Construction Equipments.

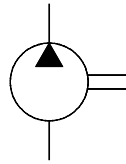

Graphic Symbol

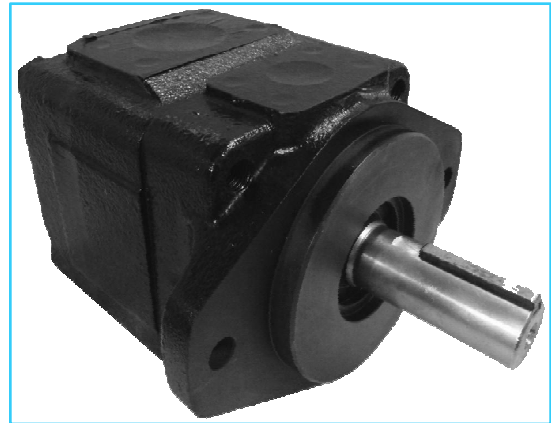

Specifications

Model Number	Y	Nominal Displacement	Geometric Displacement cm ³ /rev.	Max. Oper. Pressure Kgf/cm ²	Output Flow and Input Power	Shaft Speed Range r/min.		Mass (Approx.) Kg.	
						Max.	Min.	Flange Mtg.	Foot Mtg.
HPV3M	Port Connection	14	47.6	240	Ref. Page Nos. 211, 212 & 213	2500	400	24.0	32.3
		17	58.2						
		20	66.0						
		24	79.5						
		28	89.7						
		31	98.3						
		35	110.0						
		38	120.3						
		42	136.0						
		45	145.7						
		50	158.0						
		61	190.5	80					

Model Number Designation

HPV3M	Y	-38	-F	-R	A	A	-K1	-10
Model Number	Port connection	Nominal Displacement	Type of Mounting	Direction of Rotation	Discharge Port Position	Suction Port Position	Type of Shaft	Design* No.
					As viewed from shaft end			
HPV3M	Y: Metric port connection (Omit for UNC.)	14 17 20 24 28 31 35 38 42 45 50 61	F: Flange Mtg. L: Foot Mtg.	R: Clockwise (Normal) L: Anti-clockwise			K1- Keyed (SAE-C) K2- Keyed (no SAE) S1- Splined (SAE-C) S2- Splined (no SAE)	10

* Design numbers subject to change from 10 to 19, but installation dimensions remain as shown.

* For instructions regarding changing the port positions, consult YUKEN INDIA LTD.

Cartridge Kit Model Number

CHPV3M	-14	-R	-10
Pump Series	Nominal Displacement	Shaft Rotation	Design Number
CHPV3M	14	R: Clockwise (Normal) L: Anti-Clockwise	10
	17		
	20		
	24		
	28		
	31		
	35		
	38		
	42		
	45		
	50		
61			

* For instructions regarding replacing cartridge kit, consult YUKEN INDIA LTD.

Flanges

Note: Please refer page no. 203 for flange details.

Spare Parts List

List of Seals

Sl. No.	Name of Part	Part Number	Qty.
1	O-Ring	PKH4-0208	1
2	O-Ring	PKH4-0209	1
3	O-Ring	PKH4-0210	1
4	Backup-Ring	PKH4-0185	1
5	Oil Seal (NOK)	34.9x57.15x8.3	1

Note: When ordering the seals, please specify the seal kit number KS-HPV3-10

Foot Mounting Parts

Sl. No.	Name of Part	Part Number	Qty.
1	Mounting Bracket	PK1-10182-3	1
2	Socket Head Cap Screw	M16 x 45Lg.	2
3	Spring Washer	WS-A-16	2

Note : When ordering the Foot Mounting Parts, please specify the Kit number HPV3-L-10.

HPV3M*-*-**--*-*-10

● Flange Mounting

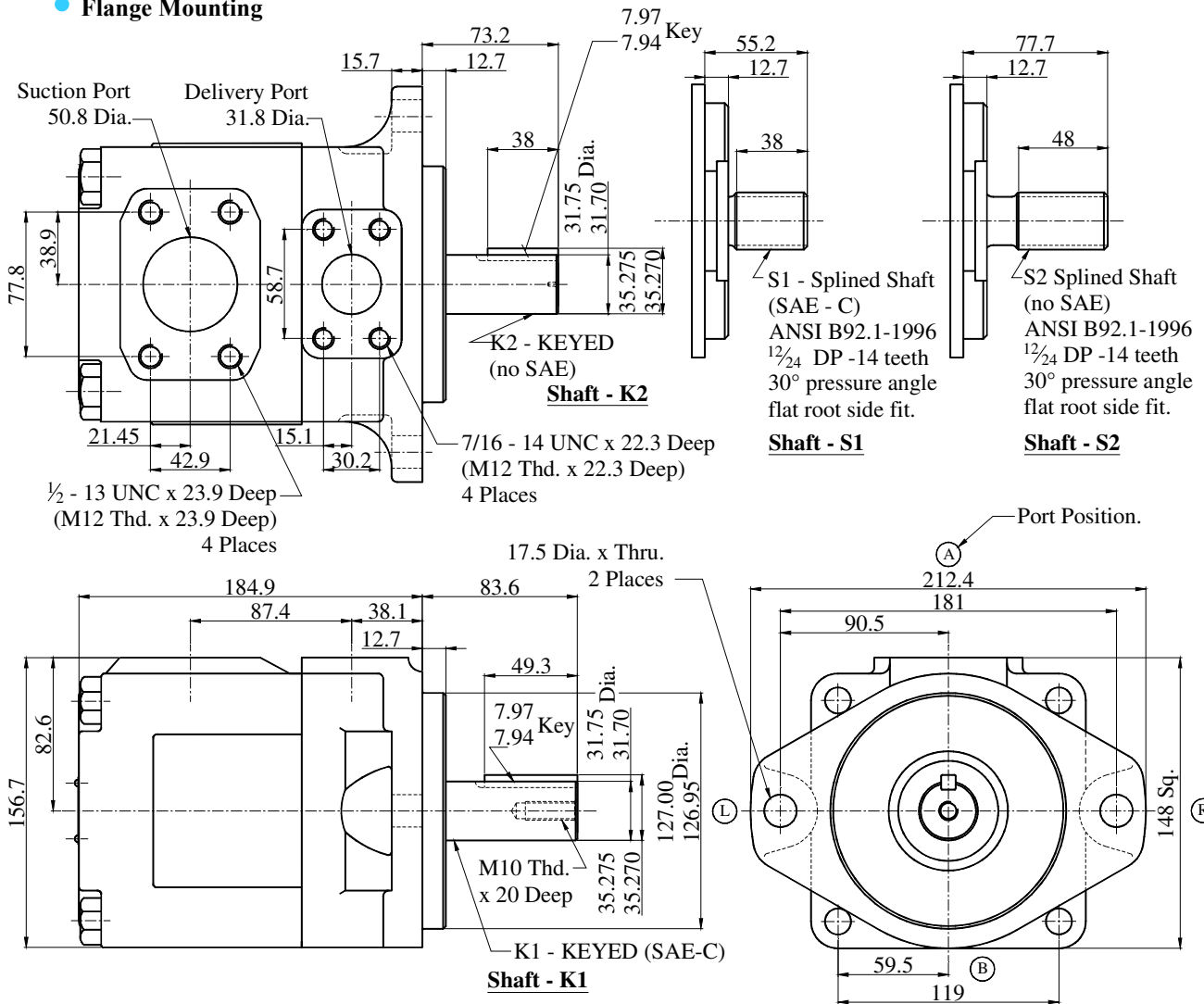

● Foot Mounting

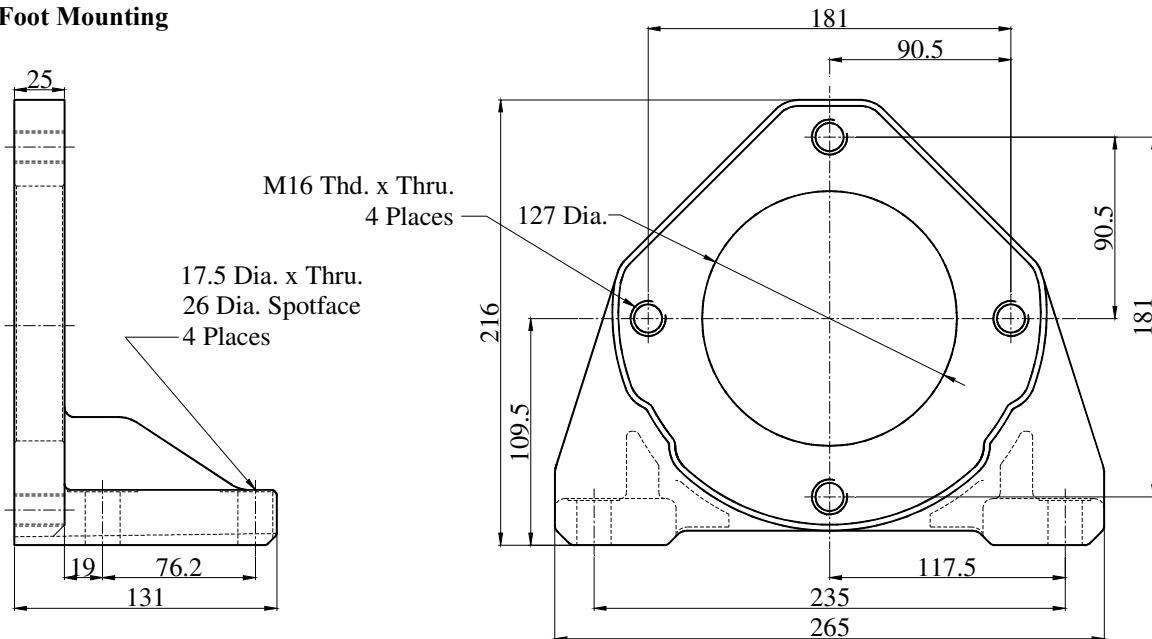

HPV3M Series Single Vane Pumps

Typical Pump Characteristics Oil Viscosity 20 cSt [ISO VG 32, Temp 50° C]

• HPV3M-14

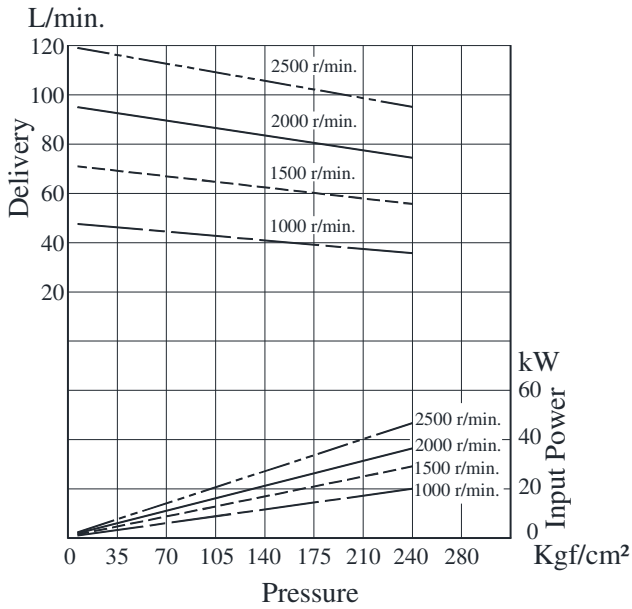

• HPV3M-17

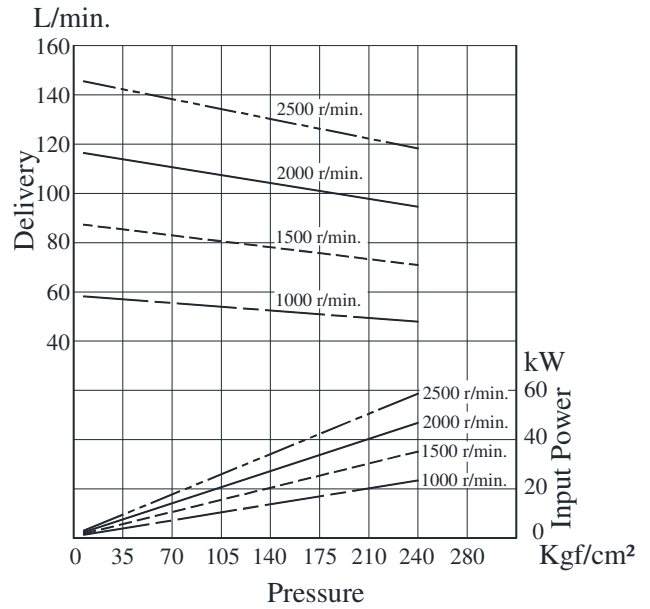

• HPV3M-20

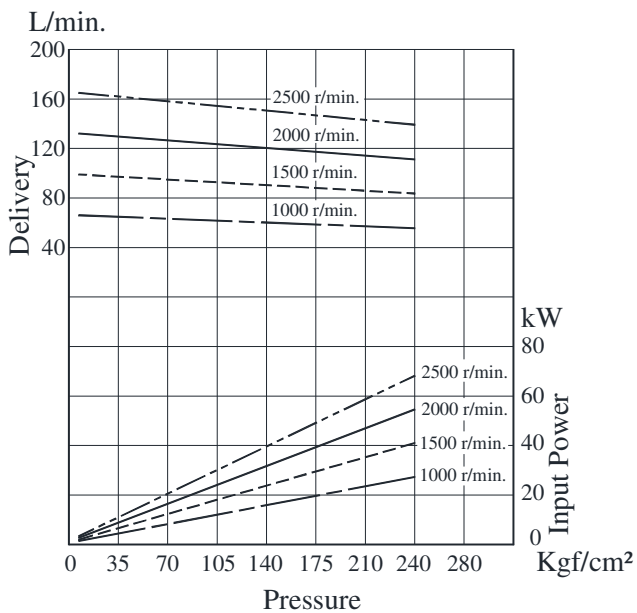

• HPV3M-24

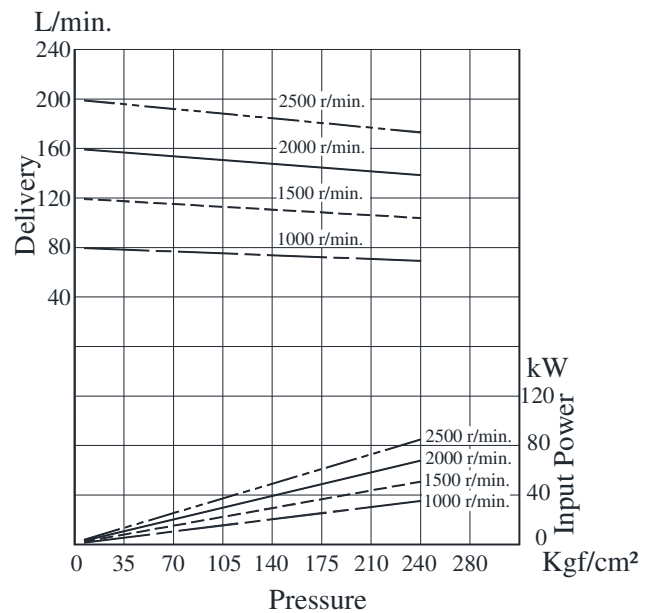

Typical Pump Characteristics Oil Viscosity 20 cSt [ISO VG 32, Temp 50° C]

● HPV3M-28

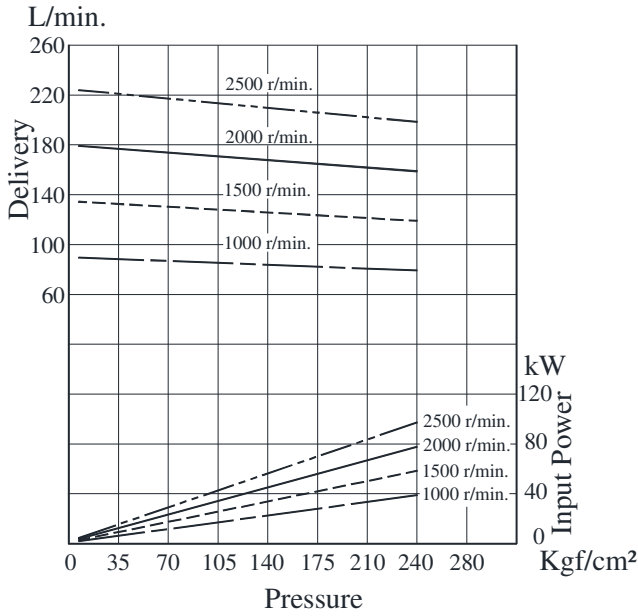

● HPV3M-31

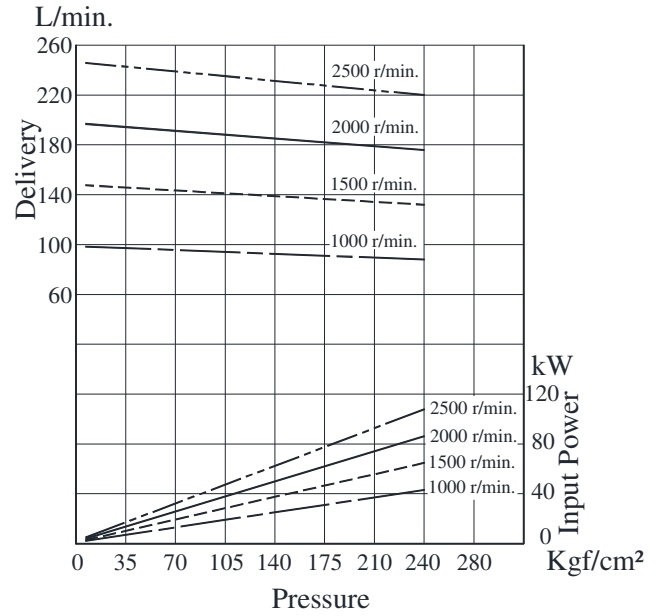

● HPV3M-35

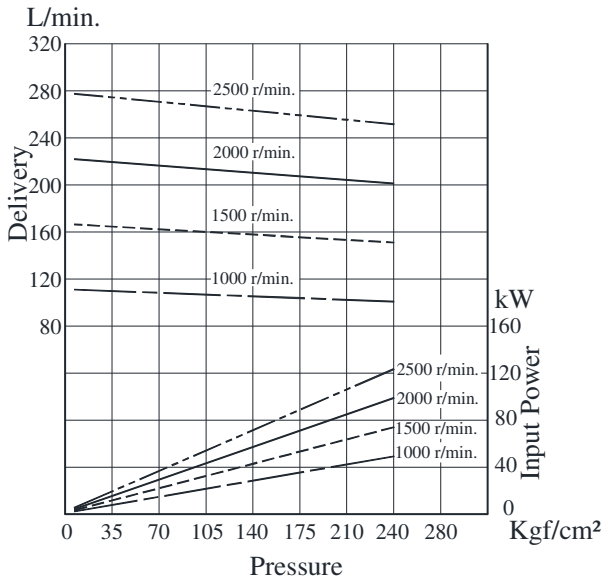

● HPV3M-38

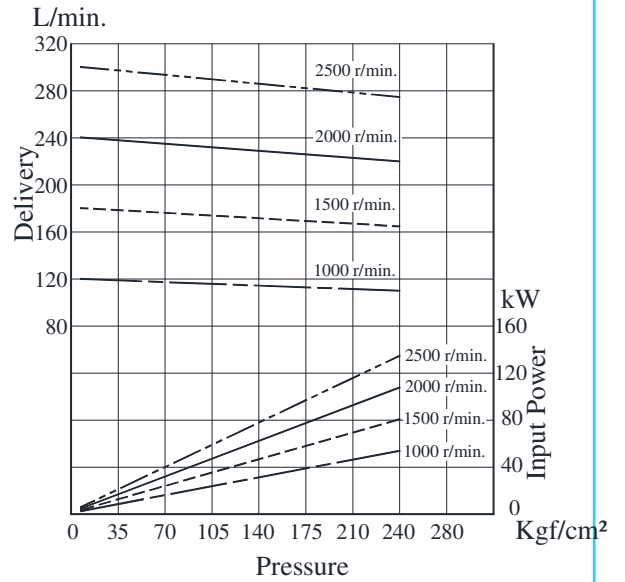

HPV3M Series Single Vane Pumps

Typical Pump Characteristics Oil Viscosity 20 cSt [ISO VG 32, Temp 50° C]

● HPV3M-42

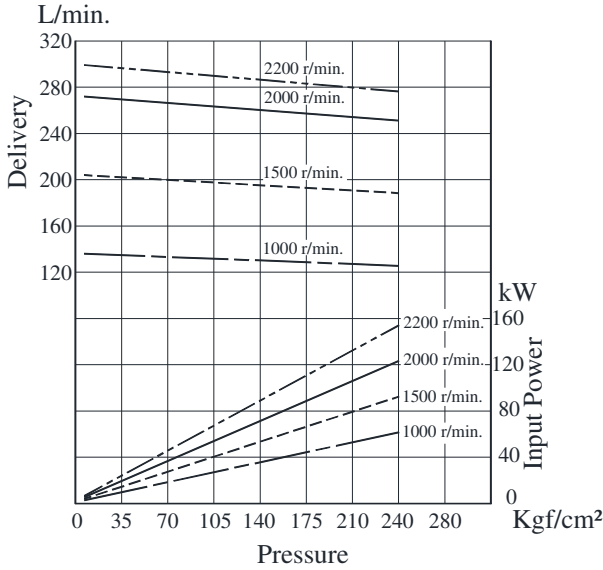

● HPV3M-45

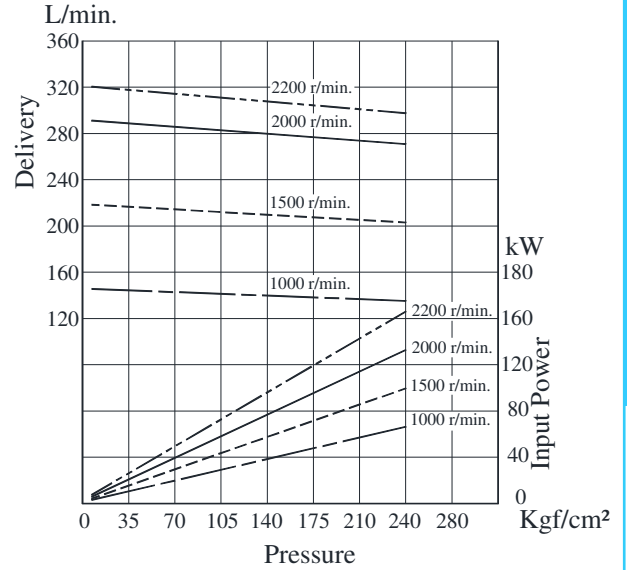

● HPV3M-50

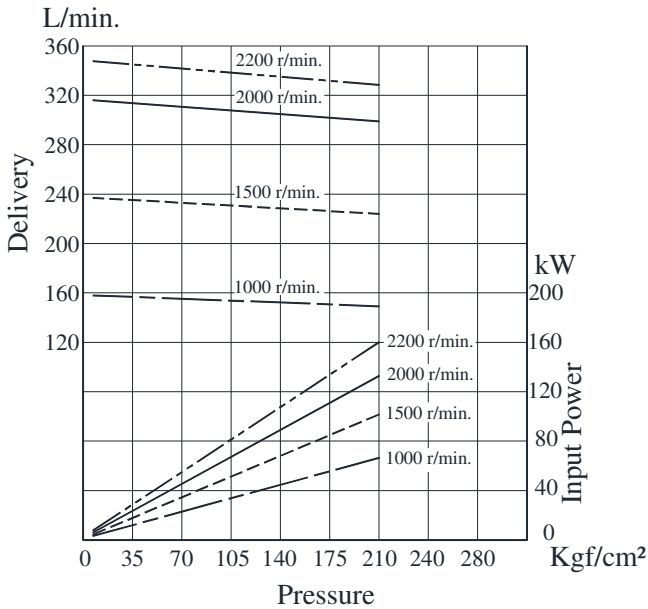

● HPV3M-61

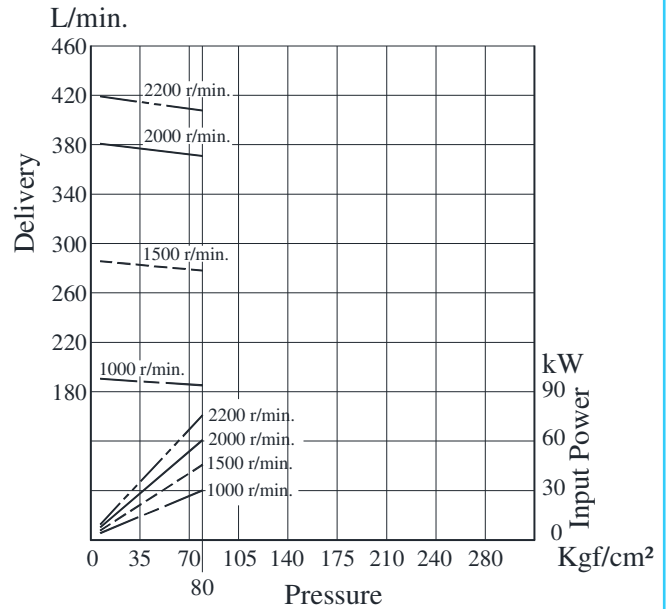

Hydraulic Fluids

Suction Pressure

Suction line pressure limit -0.20Kgf/cm^2 to $+0.3\text{Kgf/cm}^2$

Cleanliness

Contamination level should be within NAS class 9. use of $100\mu\text{m}$ (150 mesh) tank filter on suction side, above 50mm away from the tank bottom.

Alignment of Shaft

Employ a flexible coupling whenever possible & avoid stress from bending or thrust. Maximum permissible misalignment is less than 0.1mm (0.004 inches) TIR & maximum permissible misangular is less than 0.2° .

Instructions

Precautions at starting

At an initial operation or at an operation after a long rest, the pump may have difficulty in sucking up fluids. In such cases, an air bleed valve should be installed beforehand in the discharge side (Model No.ST1004-※-10※), or discharge air by slightly slackening the connection on the discharge side. At starting, operate the pump intermittently as far as possible with no load.

For fluid viscosity at starting, refer EIC-N-1001.

Other Precautions

If a pump is used at speed below 1200 r/min., install the pump with the suction port upside so that the pump can suck up fluid easily at starting.

Cartridge Kit Model Number

Pump Model Numbers	Cartridge Kit Number #
HPV2M-05-※-R※※※-※-10	CHPV2M-05-R-10
HPV2M-10-※-R※※※-※-10	CHPV2M-10-R-10
HPV2M-14-※-R※※※-※-10	CHPV2M-14-R-10
HPV2M-22-※-R※※※-※-10	CHPV2M-22-R-10
HPV2M-31-※-R※※※-※-10	CHPV2M-31-R-10
HPV3M-20-※-R※※※-※-10	CHPV3M-20-R-10
HPV3M-35-※-R※※※-※-10	CHPV3M-35-R-10
HPV3M-42-※-R※※※-※-10	CHPV3M-42-R-10
HPV3M-61-※-R※※※-※-10	CHPV3M-61-R-10

1. For instructions regarding replacing cartridge kit, consult YUKEN INDIA LTD.

The above table does not include all combinations of cartridges available.

Only a few representative samples are shown.