

SLIP-ON WELDING

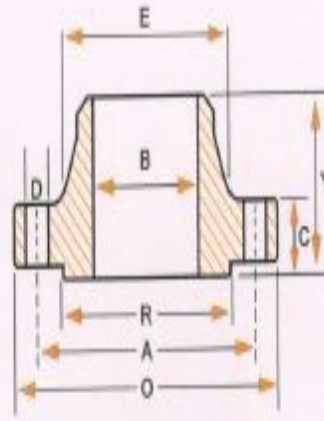

WELDING NECK

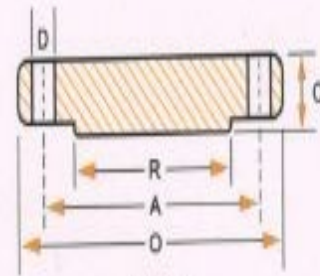

BLIND

**DIMENSIONS OF CLASS 150 FLANGES (ANSI B 16.5)**

Nominal Pipe Size (inch)	Flange Dia O (mm)	Dia of Bolt Circle A (mm)	Dia of Bolt Holes D (mm)	No. of Holes	Thk of Flange C (mm)	Dia of Hub E (mm)	Length through Hub			Dia of Bore		Dia of R/F R (mm)	Depth of Socket F (mm)	
							S/o. & S/w Y (mm)	W/N Y (mm)	L/J Y (mm)	S/O & S/W B (mm)	L/J B (mm)			
1/2	15	90	60.3	15.9	4	11.2	30	14	46	16	22.2	22.9	34.9	10
3/4	20	100	69.9	15.9	4	12.8	38	14	51	16	27.7	28.2	42.9	11
1	25	110	79.4	15.9	4	14.3	49	16	54	17	34.5	34.9	50.8	13
1.1/4	32	115	88.9	15.9	4	15.9	59	19	58	21	43.2	43.7	63.5	14
1.1/2	40	125	98.4	15.9	4	17.5	65	21	60	22	49.5	50.0	73.0	16
2	50	150	120.7	19.0	4	19.1	78	24	62	25	61.9	62.5	92.1	17
2.1/2	65	180	139.7	19.0	4	22.3	90	27	68	29	74.6	75.4	104.8	19
3	80	190	152.4	19.0	4	23.9	108	29	68	30	90.7	91.4	127.0	21
4	100	230	190.5	19.0	8	23.9	135	32	75	33	116.1	116.8	157.2	-
5	125	255	215.9	22.2	8	23.6	164	35	87	36	143.8	114.4	185.7	-
6	150	280	241.3	22.2	8	25.5	192	38	87	40	170.7	171.4	215.9	-
8	200	345	298.5	22.2	8	28.6	246	43	100	44	221.5	222.2	269.9	-
10	250	405	362.0	25.4	12	30.2	305	48	100	49	276.2	277.4	323.8	-
12	300	485	431.8	25.4	12	31.8	365	54	113	56	327.0	328.2	381.0	-
14	350	535	476.3	28.6	12	35.0	400	56	125	79	359.2	360.2	412.8	-
16	400	595	539.8	28.6	16	36.6	457	62	125	87	410.5	411.2	469.9	-
18	450	635	577.9	31.7	16	39.7	505	67	138	97	461.8	462.3	533.4	-
20	500	700	635.0	31.7	20	42.9	559	71	143	103	513.1	514.3	584.2	-
24	600	815	749.3	34.9	20	47.7	663	81	151	111	616.0	616.0	692.2	-

## DIMENSIONS OF CLASS 300 FLANGES (ANSI B 16.5)

Nominal Pipe Size (inch)	Flange Dia O	Dia of Bolt Circle A	Dia of Bolt Holes D	No. of Holes	Thk of Flange C	Dia of Hub E	Length through Hub			Dia of Bore		Dia of R/F R	Depth of Socket F	
							S/O & S/W Y	WN Y	L/J Y	S/O & S/W B	L/J B			
							Y	Y	Y	B	B			
1/2	15	95	66.7	15.9	4	14.3	38	21	51	22	22.2	22.9	34.9	10
3/4	20	115	82.6	19.0	4	15.9	48	24	56	25	27.7	28.2	42.9	11
1	25	125	88.9	19.0	4	17.5	54	25	60	27	34.5	34.9	50.8	13
1 1/4	32	135	98.4	19.0	4	19.1	64	25	64	27	43.2	43.7	63.5	14
1 1/2	40	155	114.3	22.2	4	20.7	70	29	67	30	49.5	50.0	73.0	16
2	50	165	127.0	19.0	8	22.3	84	32	68	33	61.9	62.5	92.1	17
2 1/2	65	190	149.2	22.2	8	25.4	100	37	75	38	74.6	75.4	104.8	19
3	80	210	168.3	22.2	8	28.6	117	41	78	43	90.7	91.4	127.0	21
4	100	255	200.0	22.2	8	31.8	146	46	84	48	116.1	116.8	157.2	-
5	125	298.0	235.0	22.2	8	35.0	178	49	97	51	143.8	144.4	185.7	-
6	150	320	269.9	22.2	12	36.6	206	51	97	52	170.7	171.4	215.9	-
8	200	380	330.2	25.4	12	41.3	260	60	110	62	221.5	222.2	269.9	-
10	250	445	387.4	28.6	16	47.7	321	65	116	95	276.2	277.4	323.8	-
12	300	520	450.8	31.7	16	50.8	375	71	129	102	327.0	328.2	381.0	-
14	350	585	514.4	31.7	20	54.0	425	75	141	111	359.2	360.2	412.8	-
16	400	650	571.5	34.9	20	57.2	483	81	144	121	410.5	411.2	469.9	-
18	450	710	628.6	34.9	24	60.4	533	87	157	130	461.8	462.3	533.4	-
20	500	775	685.8	34.9	24	63.5	587	94	160	140	513.1	514.3	584.2	-
24	600	915	812.8	41.3	24	69.9	702	105	167	152	616.0	616.0	692.2	-

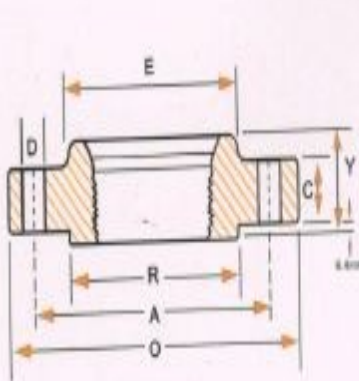

THREADED

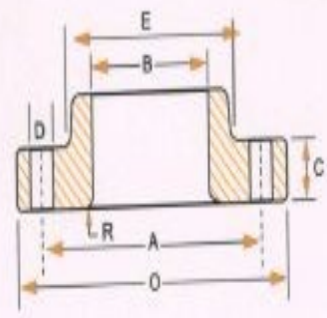

LAPPED

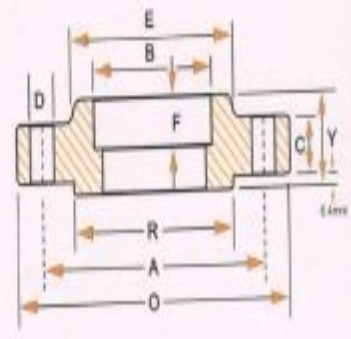

SOCKET WELDING  
(1/2 TO 3 ONLY)

**DIMENSIONS OF CLASS 600 FLANGES (ANSI B 16.5)**

Nominal Pipe Size (inch) (mm)	Flange Dia O	Dia of Bolt Circle A	Dia of Bolt Holes D	No. of Holes	Thk of Flange C	Dia of Hub E	Length through Hub			Dia of Bore		Dia of R/F R	Depth of Socket F	
							S/o. & S/w Y	W/N Y	L/J Y	S/O & S/W B	L/J B			
1/2	15	95	66.7	15.9	4	14.3	38	22	52	22	22.2	22.9	34.9	10
3/4	20	115	82.6	19.0	4	15.9	48	25	57	25	27.7	28.2	42.9	11
1	25	125	88.9	19.0	4	17.5	54	27	62	27	34.5	34.9	50.8	13
1.1/4	32	135	98.4	19.0	4	20.7	64	29	67	29	43.2	43.7	63.5	14
1.1/2	40	155	114.3	22.2	4	22.3	70	32	70	32	49.5	50.0	73.0	16
2	50	165	127.0	19.0	8	25.4	84	37	73	37	61.9	62.5	92.1	17
2.1/2	65	190	149.2	22.2	8	28.6	100	41	79	41	74.6	75.4	104.8	19
3	80	210	168.3	22.2	8	31.8	117	46	83	46	90.7	91.4	127.0	-
4	100	275	215.9	25.4	8	38.1	152	54	102	54	116.1	116.8	157.2	-
5	125	330	266.7	28.6	8	44.5	189	60	114	60	143.8	114.4	185.7	-
6	150	355	292.1	28.6	12	47.7	222	67	117	67	170.7	171.4	215.9	-
8	200	420	349.2	31.7	12	55.6	273	76	133	76	221.5	222.2	269.9	-
10	250	510	431.8	34.9	16	63.5	343	86	152	111	276.2	277.4	323.8	-
12	300	560	489.0	34.9	20	66.7	400	92	156	117	327.0	328.2	381.0	-
14	350	605	527.0	38.1	20	69.9	432	94	165	127	359.2	360.2	412.8	-
16	400	685	603.2	41.3	20	76.2	495	106	178	140	410.5	411.2	469.9	-
18	450	745	654.0	44.4	20	82.6	546	117	184	152	461.8	462.3	533.4	-
20	500	815	723.9	44.4	24	88.9	610	127	190	165	513.1	514.3	584.2	-
24	600	940	838.2	50.8	24	101.6	718	140	203	184	616.0	616.0	692.2	-



## DIMENSIONS OF CLASS 900 FLANGES (ANSI B 16.5)

Nominal Pipe Size (inch)	Nominal Pipe Size (mm)	O	A	D	No. of Holes	Thk of Flange C	Dia of Hub E	Length through Hub			Dia of Bore		Dia of R/F R	Depth of Socket F
		Flange Dia O	Dia of Bolt Circle A	Dia of Bolt Holes D				S/O & S/W Y	W/N Y	L/J Y	S/O & S/W B	L/J B		
1/2	15	120	82.8	22.2	4	22.3	38	32	60	32	22.2	22.9	34.9	10
3/4	20	130	88.9	22.2	4	25.4	44	35	70	35	27.7	28.2	42.9	11
1	25	150	101.6	25.4	4	28.6	52	41	73	41	34.5	34.9	50.8	13
1.1/4	32	160	111.1	25.4	4	28.6	64	41	73	41	43.2	43.7	63.5	14
1.1/2	40	180	123.8	28.6	4	31.8	70	44	83	44	49.5	50.0	73.0	16
2	50	215	165.1	25.4	8	38.1	105	57	102	57	61.9	62.5	92.1	17
2.1/2	65	245	190.5	28.6	8	41.3	124	64	105	64	74.6	75.4	104.8	19
3	80	240	190.5	25.4	8	38.1	127	54	102	54	90.7	91.4	127.0	-
4	100	290	235.0	31.7	8	44.5	159	70	114	70	116.1	116.8	157.2	-
5	125	350	279.4	35.0	8	50.8	190	79	127	79	143.8	114.4	185.7	-
6	150	380	317.5	31.7	12	55.8	235	86	140	86	170.7	171.4	215.9	-
8	200	470	393.7	38.1	12	63.5	298	102	162	114	221.5	222.2	269.9	-
10	250	545	469.9	38.1	16	69.5	368	108	184	127	276.2	277.4	323.8	-
12	300	610	533.4	38.1	20	79.4	419	117	200	143	327.0	328.2	381.0	-

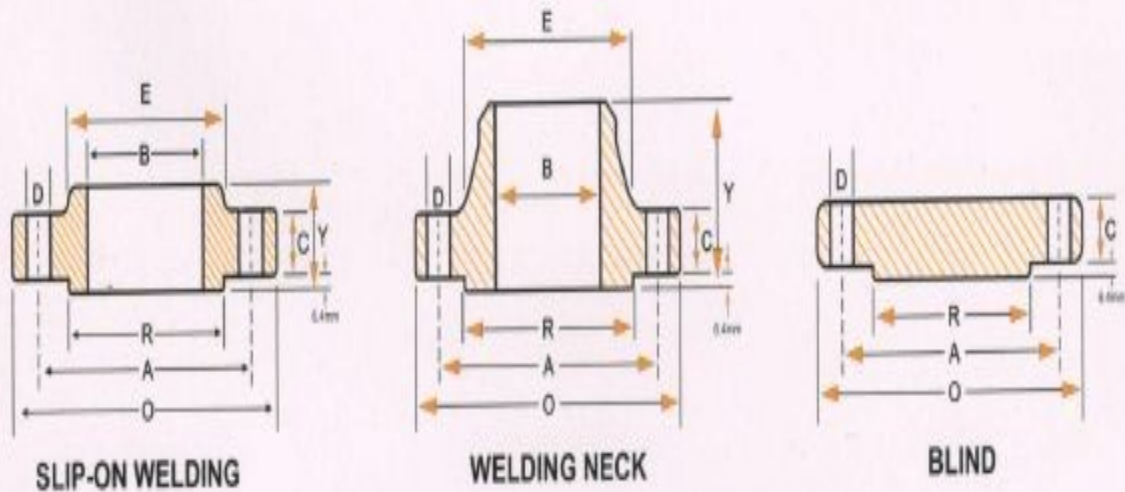

### DIMENSIONS OF CLASS 1500 FLANGES (ANSI B 16.5)

Nominal Pipe Size (inch)	Flange Dia O	Dia of Bolt Circle A	Dia of Bolt Holes D	No. of Holes	Thk of Flange C	Dia of Hub E	Length through Hub			Dia of Bore		Dia of R/F R	Depth of Socket F
							S/o. & S/w Y	W/N Y	L/J Y	S/D & S/W B	L/J B		
							Y	Y	Y	B	B		
1/2	15	82.6	22.2	4	22.3	38	32	60	32	22.2	22.9	34.9	10
3/4	20	88.9	22.2	4	25.4	44	35	70	35	27.7	28.2	42.9	11
1	25	101.6	25.4	4	28.6	52	41	73	41	34.5	34.9	50.8	13
1.1/4	32	111.1	25.4	4	28.6	64	41	73	41	43.2	43.7	63.5	14
1.1/2	40	123.8	28.6	4	31.8	70	44	83	44	49.5	50.0	73.0	16
2	50	165.1	25.4	8	38.1	105	57	102	57	61.9	62.5	92.1	17
2.1/2	65	190.5	28.6	8	41.3	124	64	105	64	74.6	75.4	104.8	19
3	80	203.2	31.7	8	47.7	133	73	117	73	90.7	91.4	127.0	-
4	100	241.3	34.9	8	54.0	162	91	124	90	116.1	116.8	157.2	-
5	125	292.1	41.3	8	73.1	197	105	156	105	143.8	144.4	185.7	-
6	150	317.5	38.1	12	82.6	229	119	171	119	170.7	171.4	215.9	-
8	200	393.7	44.4	12	92.1	292	143	213	143	221.5	222.2	269.9	-
10	250	482.6	50.8	12	105.0	368	159	254	178	276.3	277.4	323.8	-
12	300	571.5	54.0	16	123.9	451	181	283	219	327.1	328.2	381.0	-

## DIMENSIONS OF CLASS 2500 FLANGES (ANSI B 16.5)

Nominal Pipe Size (inch)	mm	O	A	D	No. of Holes	C	E	Length through Hub			Dia of Bore		R	F
		Flange Dia O	Dia of Bolt Circle A	Dia of Bolt Holes D		Thk of Flange C	Dia of Hub E	S/O & S/W Y	W/N Y	LJ Y	S/O & S/W B	LJ B	Dia of R/F R	Depth of Socket F
1/2	15	135	88.9	22.2	4	30.2	43	40	73	40	22.3	22.9	34.9	10
3/4	20	140	95.2	22.2	4	31.8	51	43	79	43	28.2	28.2	42.9	11
1	25	160	108.0	25.4	4	35.0	57	48	89	48	34.9	34.9	50.8	13
1.1/4	32	185	130.2	28.6	4	38.1	73	52	95	52	43.7	43.7	63.5	14
1.1/2	40	205	146.0	31.7	4	44.5	79	60	111	60	50.0	50.0	73.0	16
2	50	235	171.4	28.6	8	50.9	95	70	127	70	62.5	62.5	92.1	17
2.1/2	65	265	196.8	31.7	8	57.2	114	79	143	79	75.4	75.4	104.8	19
3	80	305	228.6	34.9	8	66.7	133	92	168	92	91.4	91.4	127.0	-
4	100	355	273.0	41.3	8	76.2	165	108	190	108	116.8	116.8	157.2	-
5	125	420	323.8	47.6	8	92.1	203	130	229	130	144.4	144.4	185.7	-
6	150	485	368.3	54.0	8	108.0	235	152	273	152	171.4	171.4	215.9	-
8	200	550	438.2	54.0	12	127.0	305	178	318	178	222.2	222.2	269.9	-
10	250	675	539.8	66.7	12	165.1	375	229	419	229	277.4	277.4	323.8	-
12	300	760	619.1	73.0	12	184.2	441	254	464	254	328.2	328.2	381.0	-